



FC Adaptor

Lightem offers a wide variety of adaptor configuration for meeting almost any application. Patching, attaching the two connectors together in perfect alignment condition, is always the critical part of the network. Couplers, hybrid adaptors, male to female type adaptors or bare fiber adaptor are available.

Lightem FC adaptor series covers the very board range of designs in the market, including the rare SC hole mount type. FC is one of the most popular type fiber interface in the market. Standard square, D type or even flanged type can be found from Lightem. Quality sleeve is used as the core part at the adaptor for providing a precise alignment. Use the chart below to select the most appropriate type for your application.

Features

- Premium quality sleeve with precise alignment
- Low insertion loss
- Very broad variety of choices, simplex and duplex with different colours
- Fully in compliance with JIS C5973 F04 type connector specifications.
- Precision mechanical dimensions.

Specifications

Item	Parameter
Insertion Loss	≤0.2 dB
Durability	0.2 dB Max
Withdrawal Force (g/f)	200 ~ 600
Operating Temperature	-40°C ~ +85°C
Standard	Compliant with JISC5974, Bellcore GR-326, IEC61754-4, TIA / EIA 568B, IEC60874-10, Telcordia, JIS compliance
Type	D-shaped and Rectangular mount

Solid Body Type

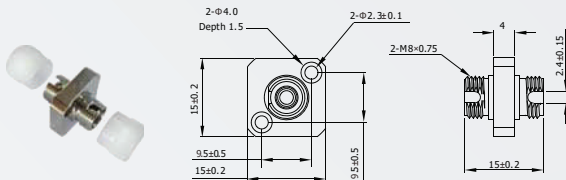

Twin Type

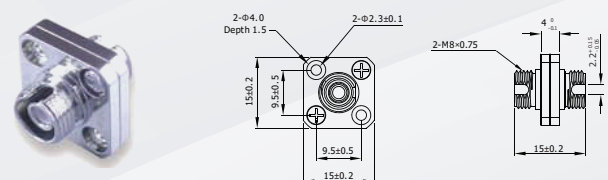

SC Footprint Type

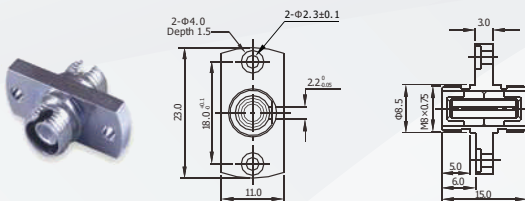

D1 Type

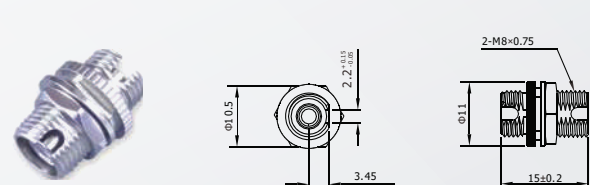

D3 Type

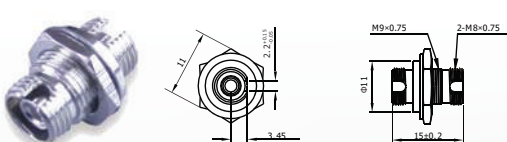

D4 Type

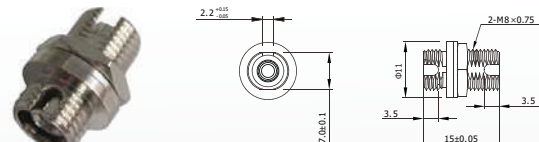

Ordering Information

* Ordering Code Example

